

# SERVICE MANUAL

*Relex* 36N-7

SER. NO. HY36N0001~

 **HYUNDAI**  
HEAVY INDUSTRIES CO.,LTD.

# INTRODUCTION

To insure a long life for the machine and the engine and to prevent failure and problems, proper operation, maintenance and repairs are imperative.

This service manual includes an “outline,” “structure and operation,” “inspection and adjustment,” “disassembly and assembly,” “standard maintenance,” and “repair and replacement of parts” of the machine which are necessary to carry out the inspections and repairs in the repair shop.

We trust that this manual will help you to effectively carry out the necessary. Repairs should they arise, also provide a accurate description of the product, and the correct repair procedures.

# CONTENTS

1. Precautions on Maintenance
2. Outline
3. Attachment
4. Engine
5. Main Pump
6. Hydraulic Oil Filter
7. Control Valve
8. Joystick  
(Pilot Valve)
9. Pilot Valve (1)  
(Travel)
10. Pilot Valve (2)  
(Dozer)
11. Slew Motor
12. Travel Motor
13. Hydraulic Cylinder
14. Swivel Joint
15. Crawler
16. Spring Case and Grease Cylinder
17. Idler
18. Sprocket
19. Track Roller
20. Carrier Roller
21. Electrical Equipment
22. Troubleshooting

# 1 PRECAUTIONS ON MAINTENANCE

## 1. Correct operation

Correct operation means to follow the correct “procedure” and “method.”

Procedure focuses on speed and accuracy of each job.

In the method, are addressed what type of facility, tools, instruments, materials, oil should be used, how and which part should be checked, adjusted or disassembled, and what matters to attend to.

## 2. Precautions on operation

### 1. Safety check

Check that stoppers and sleepers are correctly installed for the vehicle jack-up operation.

### 2. Preparation

Prepare all of the tools and inspect and adjust the instruments.

### 3. For efficiency

#### 1) Understand the state before disassembly.

What is the problem? Is disassembly absolutely necessary?

#### 2) Before disassembly

Determine whether match marks are necessary. For the electrical system, disconnect the cable from the battery terminal.

#### 3) Precautions for disassembly

In stead of checking all of the disassembled parts at once, check each part individually as it is disassembled. When removing the hydraulic unit or the hoses, mount a dust cap on the connection.

#### 4) Repair of disassembled parts

Keep the disassembled parts in order. Clearly distinguish the parts to be replaced with new parts from those to be reused. Packings, seals, rings, split pins must be replaced.

#### NOTE:

Electrical equipment, rubbers and V belts (which are easily affected by water and oil) must be handled carefully in order to prevent soiling them.

#### 5) Clean disassembled parts

Thoroughly clean the disassembled parts.

#### 6) Assembly

Perform the assembly correctly (tightening torque, application of Three Bond, screw lock, grease, use of seal tape, etc.). Also install the hose correctly.

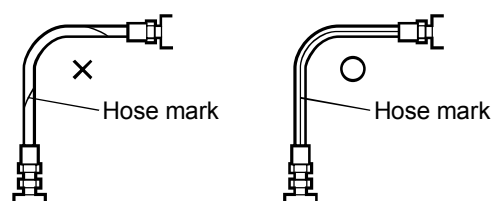

## **2** OUTLINE

### **CONTENTS**

- 2-1 Location of serial No.
- 2-2 Name of each part
- 2-3 Dimensions and specification
  - 2-3-1 PTO flow
- 2-4 Weight list
- 2-5 Oil and grease supply points
- 2-6 List of supply oil and grease
- 2-7 When to repair
- 2-8 Hydraulic circuit diagram

## 2-1 Location of Serial Number

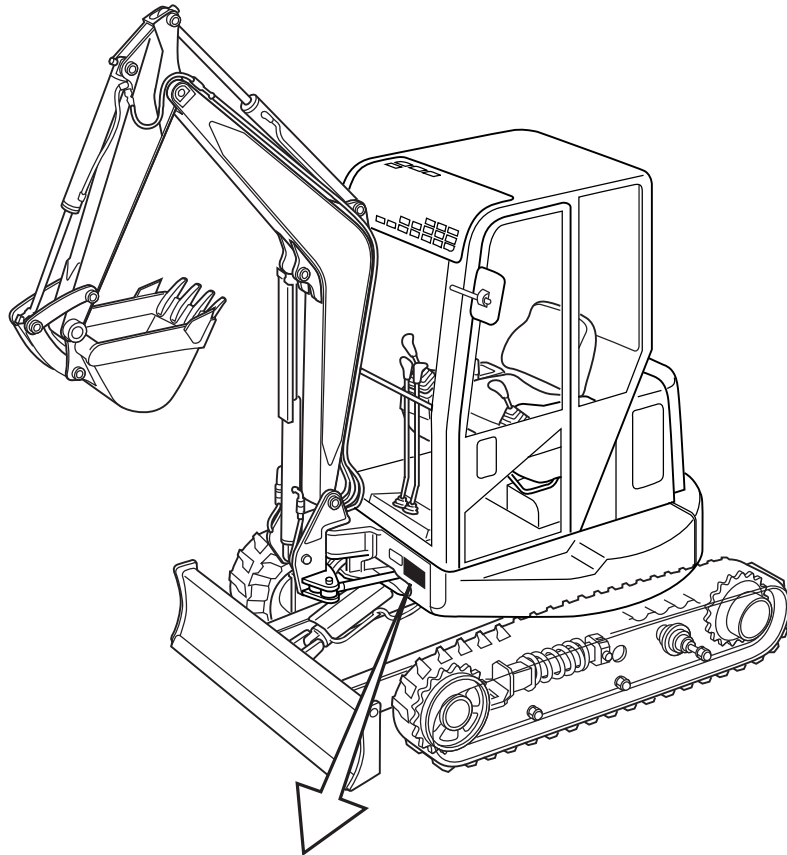

<b>CE</b> <b>HYUNDAI</b> HEAVY INDUSTRIES CO., LTD Ulsan, Korea	
EQUIPMENT	OPERATING WEIGHT
MODEL	ENGINE POWER(P/S/KW/hp/m)
SERIAL NUMBER	MFG. YEAR
DO NOT DEFACE OR REMOVE THIS PLATE	

## 2-2 Name of each part

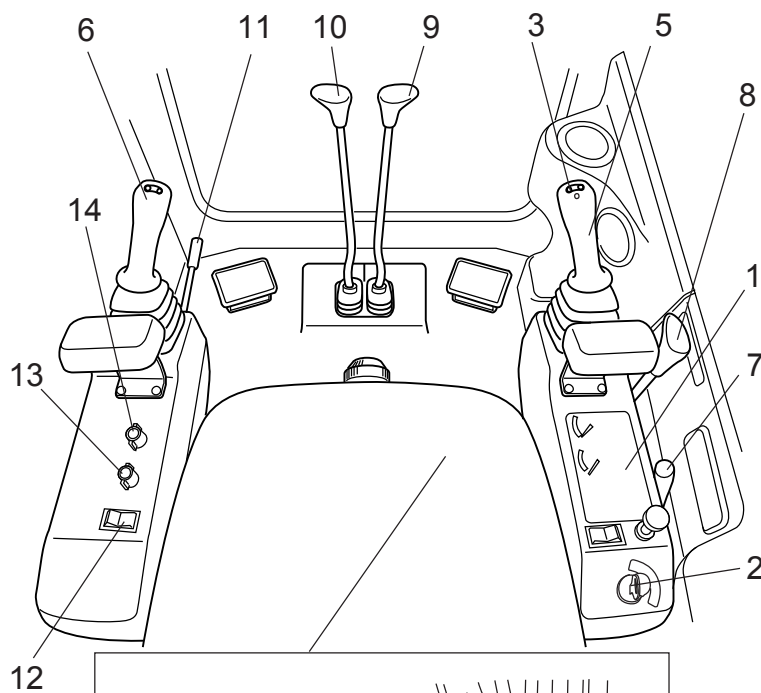

1. Meter unit
2. Starter switch
3. Horn switch
4. Fuse box
5. Right operation lever
6. Left operation lever
7. Accelerator lever
8. Dozer lever
9. Right travel lever
10. Left travel lever
11. Safety lock lever
12. Over drive switch
13. Heater switch
14. Wiper switch
15. Manual boom lower lever
16. Cigarette lighter

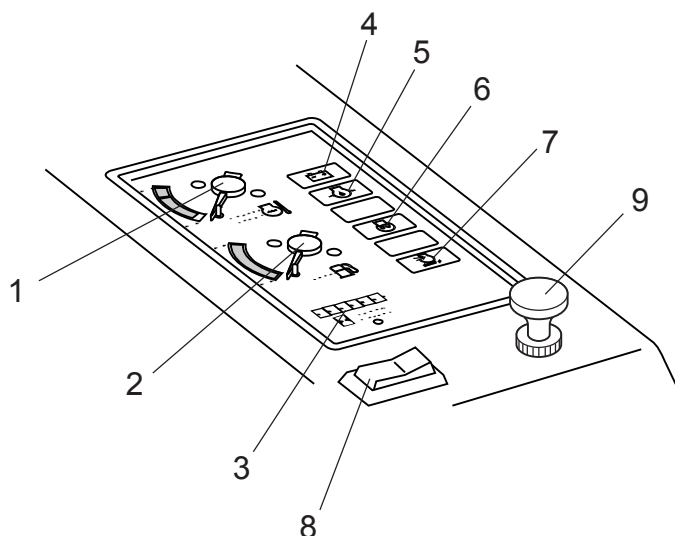
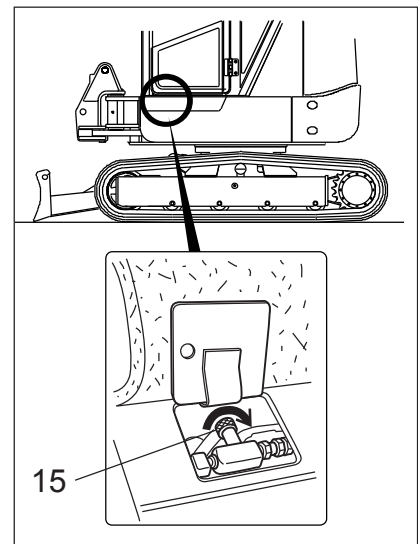
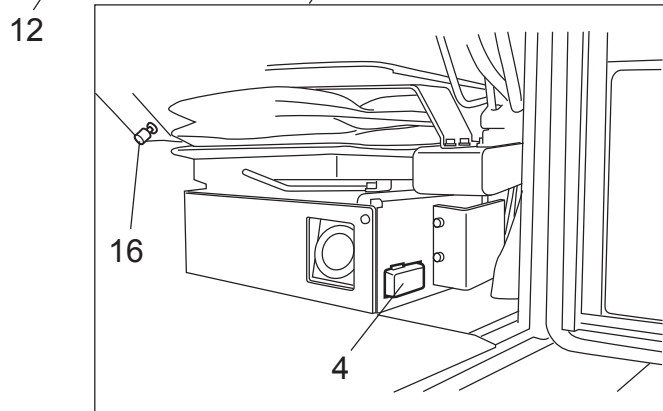

1. Water temperature meter
2. Fuel gauge
3. Hour meter
4. Charge lamp
5. Engine oil pressure lamp
6. Glow lamp
7. Air filter lamp
8. Head light switch
9. Heater change lever  
(cold ↔ warm)

## 2-3 Dimensions and Specifications

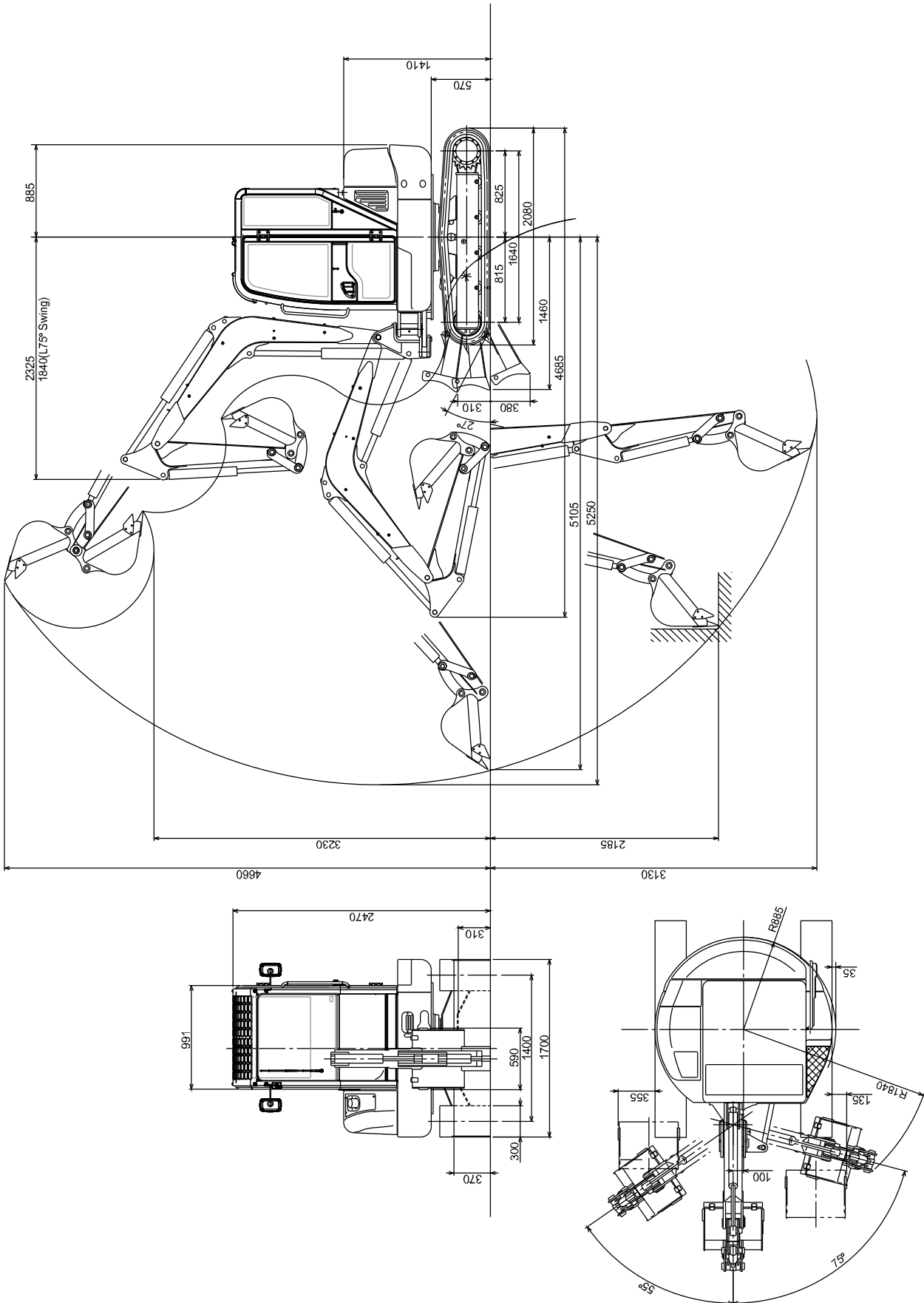



Model			Robex36N-7	
Machine weight	Canopy rubber		Kg	–
	Canopy steel			–
	Cabin rubber			3,620
	Cabin steel			3,700
Standard bucket capacity / width			m <sup>3</sup> / mm	0.11 / 590
Engine	Type		MITSUBISHI S3L2	
	Displacement		cc	1,318
	Rated output		kW(PS) / min <sup>-1</sup>	19.9 (27.0) / 2400
Dimensions	Overall length		mm	4,685
	Overall width			1,700
	Overall height			2,470
Working range	Max.digging depth		mm	3,130
	Max.vertical digging depth			2,185
	Max.digging height			4,660
	Max.dumping height			3,230
	Max.digging radius			5,250
	Reach at ground			5,105
	Min.turning radius	Front		2,325
		Swing		1,840
	Rear turning radius			885
Boom swing angle L/R		deg	75 / 55	
Performance	Max.digging force	Bucket	kN	30.1
		Arm		18.7
	Traction force			32.1
	Travelling speed (low) / (high)		km / h	2.5 / 4.5
	Slew speed		min <sup>-1</sup>	8.0
	Gradeability		Angle	30°
Hydraulic system	Pump	Type	Piston 2 + Gear 1	
		Oil flow	lit. / min	42.0 / 42.0 / 25.2
	PTO	Oil flow	lit. / min	67.2
	Main relief pressure		MPa	20.6 / 20.6 / 17.2
Underbody	Doze blade width × height		mm	1,700 × 370
	Shoe width × tumbler center			300 × 1,640
	Ground pressure	Cabin rubber	kPa	32.8
		Cabin steel		33.7
	Type of travel motor		Piston shoe-in type	
Crawler tension system		Grease cylinder		
Capacity	Hyd. tank capacity		lit.	42.0
	Fuel tank capacity			41.0
	Engine oil capacity			4.5
	Cooling water capacity			5.5
Noise level Lwa / Lpa			dB	94 / 79

**BUY NOW**

**Then Instant Download  
the Complete Manual  
Thank you very much!**