

# John Deere JD760 Series-A Scraper

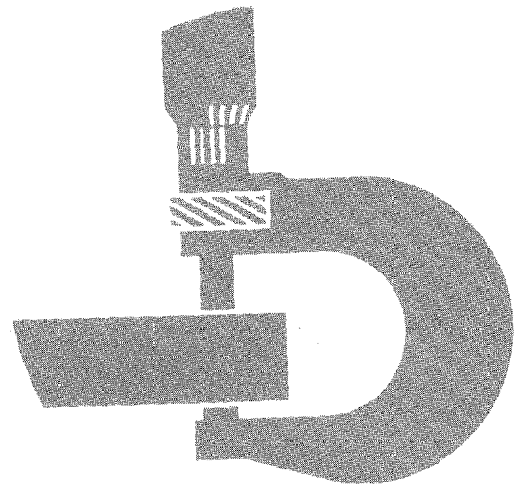

## TECHNICAL MANUAL

**TM-1018**  
Litho in U.S.A. (T) Revised

# JD760 SERIES-A SCRAPER

## Technical Manual TM-1018 (Jan-74)

### CONTENTS

- SECTION 10 - GENERAL
- Group 5 - Specifications
  - Group 10 - Predelivery, Delivery and After-Sales Services
  - Group 15 - Tune-up and Adjustment
  - Group 20 - Lubrication
  - Group 25 - Separation
- SECTION 20 - ENGINE
- Group 5 - Basic Engine
  - Group 10 - Lubrication System
  - Group 15 - Cooling System
  - Group 20 - Speed Control Linkage
- SECTION 30 - FUEL SYSTEM
- Group 5 - Diagnosing Malfunctions
  - Group 10 - Fuel Tank, Transfer Pump, and Filters
  - Group 15 - Air Intake System
  - Group 20 - Fuel Injection Pump
- SECTION 40 - ELECTRICAL SYSTEM
- Group 5 - Information and Diagrams
  - Group 10 - Charging Circuit
  - Group 15 - Starting Circuit
  - Group 20 - Lighting and Accessory Circuits
- SECTION 50 - POWER TRAIN
- Group 5 - Transmission Disconnect Clutch
  - Group 10 - Power Shift Transmission
  - Group 15 - Differential
  - Group 20 - Final Drives
  - Group 25 - Reversible Power Take-Off
- SECTION 60 - STEERING AND BRAKES  
(SEE SECTION 70)
- SECTION 70 - HYDRAULIC SYSTEM
- Group 5 - General Information, Diagnosis and Testing
  - Group 10 - Filters, Valves, Oil Cooler, and Accumulators
  - Group 15 - Hydraulic Pump
  - Group 20 - Power Steering
  - Group 25 - Power Brakes
  - Group 30 - Control Valve (Functions)
  - Group 35 - Cylinders
- SECTION 80 - MISCELLANEOUS
- Group 5 - Elevator
  - Group 10 - Drive Shafts
  - Group 15 - Draft Frame Gearbox
  - Group 20 - Elevator Gearbox
  - Group 25 - Wheels and Axle Assemblies
  - Group 30 - Bowl Components
  - Group 35 - Seat Assembly
  - Group 40 - Cab Pressurizer
- INDEX

*The specifications and design information contained in this manual were correct at the time it was printed. It is John Deere's policy to continually improve and update our machines. Therefore, the specifications and design information are subject to change without notice. Wherever applicable, specifications and design information are in accordance with SAE and IEMC standards.*

Copyright 1969  
DEERE & COMPANY  
Moline, Illinois  
All rights reserved

## INTRODUCTION

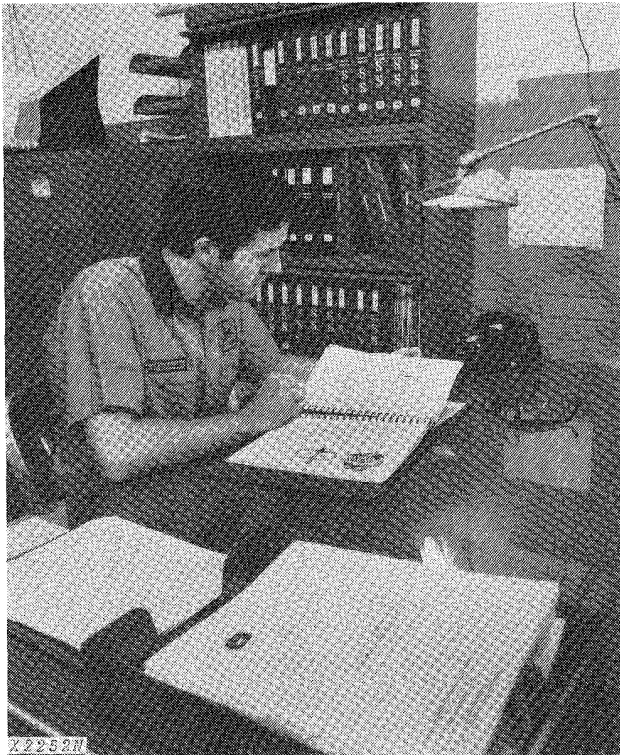

Use FOS Manuals for Reference



Use Technical Manuals for Actual Service

This technical manual is part of a twin concept of service:

- **FOS Manuals**—for reference
- **Technical Manuals**—for actual service

The two kinds of manuals work as a team to give you both the general background and technical details of shop service.

*Fundamentals of Service (FOS) Manuals* cover basic theory of operation, *fundamentals* of trouble shooting, *general* maintenance, and *basic* types of failures and their causes. FOS Manuals are for training new men and for reference by experienced men.

*Technical Manuals* are concise service guides for a *specific* machine. Technical Manuals are on-the-job guides containing only the vital information needed by a journeyman mechanic.



When a serviceman should refer to a FOS Manual for more information, a FOS symbol like the one at the left is used in the TM to identify the reference.

Some features of this technical manual:

- *Table of contents at front of manual*
- *Exploded views showing parts relationship*
- *Photos showing service techniques*
- *Specifications grouped for easy reference*

This technical manual was planned and written for you—a journeyman mechanic. Keep it in a permanent binder in the shop where it is handy. Refer to it whenever in doubt about correct service procedures or specifications.

Using the technical manual as a guide will reduce error and costly delay. It will also assure you the best in finished service work.



This safety alert symbol identifies important safety messages in this manual. When you see this symbol, be alert to the possibility of personal injury and carefully read the message that follows.





**DIMENSIONS**

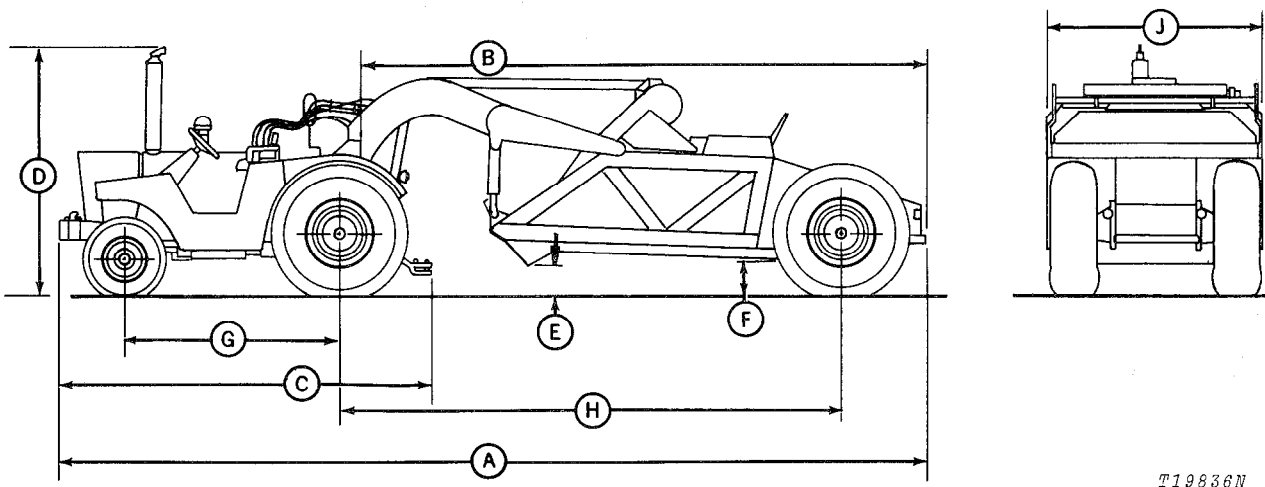

Fig. 1-JD760 Series-A Scraper Dimensions

T19836N

	<u>Bowl Up</u>	<u>Bowl Down</u>
A. Overall Length	32 ft. 10-1/2 in.	33 ft. 7-1/2 in.
B. Scraper Length (to Swivel)	21 ft. 8-1/4 in.	22 ft. 3-1/4 in.
C. Overall Tractor Length	13 ft. 1-1/2 in.	13 ft. 1-1/2 in.
D. Overall Height	9 ft. 1-1/4 in.	9 ft. 1-1/4 in.
E. Blade Above Ground (Center Blade, Extended)	17-3/4 in.	.....
F. Clearance, Rear Frame - Minimum	16-1/4 in.	13-1/2 in.
G. Tractor Wheel Base	7 ft. 11-1/2 in.	7 ft. 11-1/2 in.
H. Scraper Wheel Base	18 ft. 7-1/8 in.	19 ft. 4-3/4 in.
J. Maximum Width	8 ft.	8 ft.

The specifications and design information contained in this manual were correct at the time this machine was manufactured. It is John Deere's policy to continually improve and update our machines. Therefore the specifications and design information are subject to change without notice. Wherever applicable, specifications and design information are in accordance with SAE and IEMC standards.

**BUY NOW**

**Then Instant Download  
the Complete Manual  
Thank you very much!**