

**SERVICE MANUAL &
TECHNICAL BULLETIN**

MODEL J01-J02 SERIES

INTRODUCTION

This service manual has been prepared to provide necessary information concerning the maintenance and repair procedures for the NISSAN FORKLIFT J01 and J02 series.

Any changes effected in the series after publication of this service manual will be announced in a technical bulletin. It is, therefore, recommended that each relevant technical bulletin be inserted in front of each section and be used together with the service manual as a reference.

If a new model requires different service method or has undergone a major change, revised sections will be issued to replace the applicable sections. Each revised section will include the description of how to service the parts for the former specifications. The publication of a revised section will be announced in the technical bulletin.

This service manual consists of twenty-one sections as shown in the following table, which gives the updated symbols. When a revised service manual is issued, this "INTRODUCTION" sheet should be replaced with a revised one.

Section	Symbol
GENERAL INFORMATION	(GI)
MAINTENANCE	(MA)
ENGINE TUNE-UP (H15, H20-II, H25 ENGINE)	(ET)
ENGINE MECHANICAL (H15, H20-II, H25 ENGINE)	(EM)
ENGINE LUBRICATION & COOLING SYSTEMS (H15, H20-II, H25 ENGINE)	(LC)
ENGINE FUEL (H15, H20-II, H25 ENGINE)	(EF)
ENGINE ELECTRICAL (H15, H20-II, H25 ENGINE)	(EE)
ENGINE REMOVAL	(ER)
CLUTCH	(CL)
MANUAL TRANSMISSION	(MT)
AUTOMATIC TRANSMISSION	(AT)
DIFFERENTIAL CARRIER	(DF)
FRONT AXLE	(FA)
REAR AXLE	(RA)
BRAKE SYSTEM	(BR)
STEERING SYSTEM	(ST)
HYDRAULIC SYSTEM	(HD)
LOADING MECHANISM	(LM)
ENGINE CONTROL, FUEL & EXHAUST SYSTEMS	(FE)
BODY & FRAME	(BF)
BODY ELECTRICAL	(BE)

Edition: May 1993
Printing: July 1997 (02)
Publication No. SM3E-J012G0

GENERAL INFORMATION (GI)

MODEL JO1 & JO2 SERIES

CONTENTS

PRECAUTIONS	GI- 2
GENERAL VIEWS	GI- 3
MODEL VARIATION	GI- 4
IDENTIFICATION NUMBERS	GI- 7
ENGINE SERIAL NUMBER	GI- 7
CHASSIS SERIAL NUMBER	GI- 7
LIFT TRUCK IDENTIFICATION PLATE	GI- 7
TRANSMISSION SERIAL NUMBER	GI- 7
LOAD CHART	GI- 8
LIFTING POINTS AND TOWING	GI- 8
APPROXIMATE WEIGHT	GI- 8
LIFTING POINTS	GI-10
LIFTING UP FORKLIFT TRUCK	GI-12
TOWING	GI-12
SPECIAL SERVICE TOOLS	GI-12
TIGHTENING TORQUE OF STANDARD BOLTS	GI-13

PRECAUTIONS

PRECAUTIONS

The following precautions should be observed to ensure safe and proper service operations. These precautions are not described in each individual section.

1. Only qualified and authorized personnel should be permitted to maintain, repair, adjust and inspect the lift truck.
2. Do not operate the engine for an extended period of time without proper exhaust ventilation. Keep the work area well ventilated and free of any inflammable materials. Special care should be taken when handling any inflammable or poisonous materials, such as gasoline, refrigerant gas, etc. When working in a pit or other enclosed area, be sure to properly ventilate the area before working with hazardous materials. Do not smoke while working on the lift truck.
3. Keep the work area and tools clean.
4. Before starting repairs or examining the lift truck, remove rings and jewelry to prevent an accidental short circuit.
5. Before starting repairs which do not require battery power, always turn off the ignition switch, then disconnect the ground cable from the battery to prevent accidental short circuit.

6. To prevent serious burns, avoid contact with hot metal parts such as the radiator, exhaust manifold, tail pipe and muffler. Do not remove the radiator cap when the engine is hot.
7. Be extremely careful when jacking up and supporting the lift truck for any reason.
 - Before jacking up the lift truck, apply chocks to the wheels to prevent the lift truck from moving.
 - Place the lift truck on level concrete.
 - Do not jack up the lift truck if it is on gravel, blacktop or dirt.
 - Ensure that the wooden blocks used to support the lift truck are strong and stable one-piece units. Never pile one unit on top of the other.
 - Never get under the lift truck while it is supported only by the wooden blocks.
 - When removing engine and counterweight, the lift truck should not be put on the wooden blocks or stands. Only the wheels should be blocked.
8. Clean all disassembled parts in the designated liquid or solvent prior to inspection or assembly.

9. Replace oil seals, gaskets, packings, O-rings, locking washers, cotter pins, self-locking nuts, etc. as instructed and discard used ones.
10. Tapered roller bearings and needle bearings should be replaced as a set of inner and outer races.
11. Arrange the disassembled parts in accordance with their assembled locations and sequence.
12. After disconnecting vacuum hose or air hose, attach a tag which indicates the proper connection to prevent incorrect connection.
13. Use only the lubricants specified in the applicable section or those indicated under "Recommended Lubricants".
14. Use approved bonding agents, sealants or their equivalents when required.
15. The use of the proper tools and recommended essential tools should be used where specified for proper, safe and efficient service repairs.
16. When effecting repairs on the fuel, oil, water, intake or exhaust systems, make certain to check all affected lines for leaks.
17. Dispose of drained oil or the solvent used for cleaning parts in an appropriate manner.

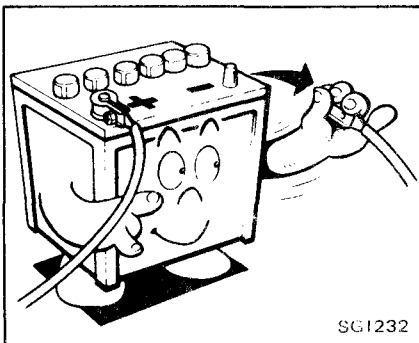

GENERAL VIEWS

GENERAL VIEWS

MODEL J01, J02 SERIES

Pneumatic tire models

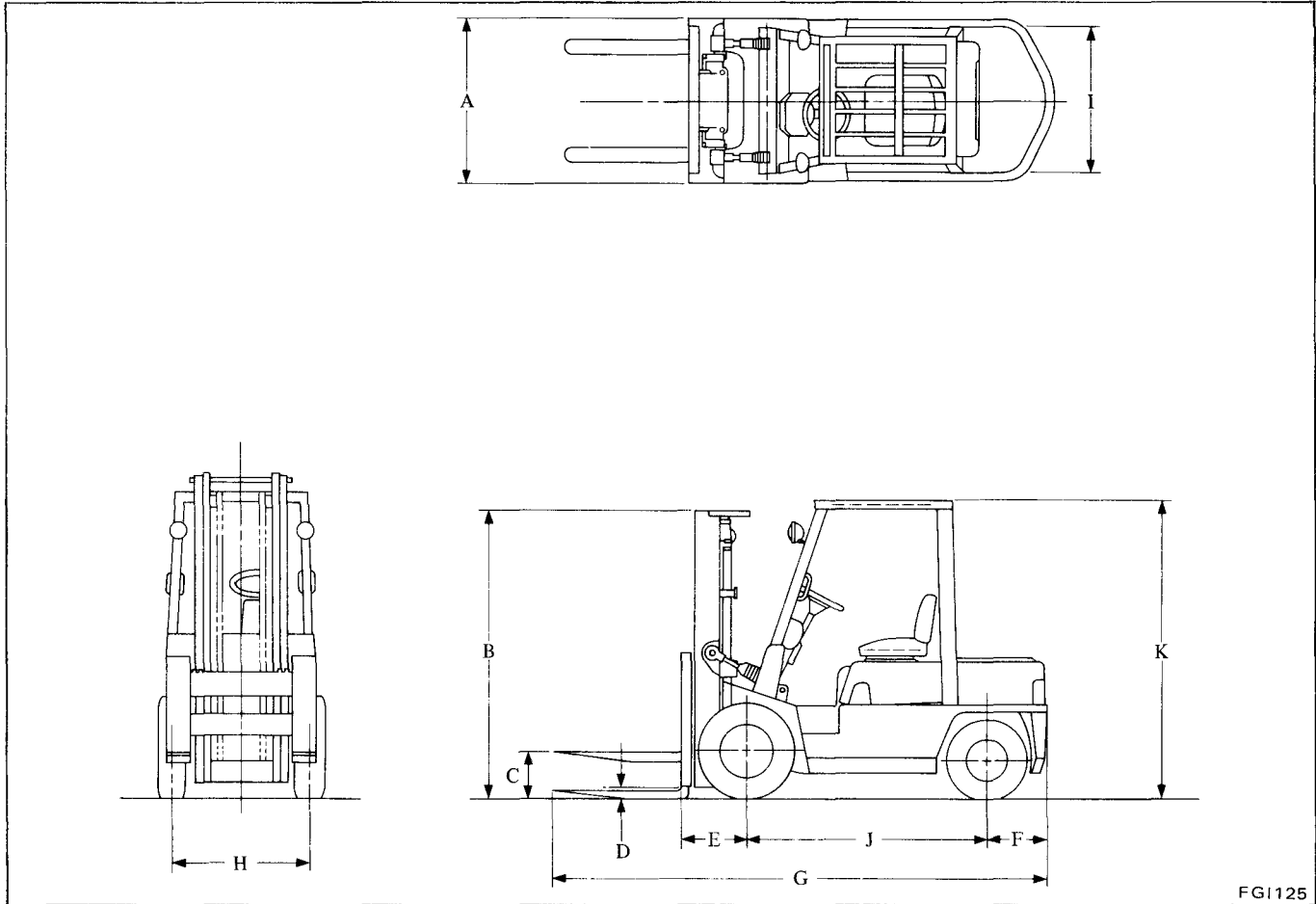

FGI125

Unit: mm (in)

	J01A10U/ M10U PJ01A10U FJ01A10U/ M10U	J01A14U/ M14U PJ01A14U	J01A15U/ M15U PJ01A15U FJ01A15U/ M15U	J01A18U/ M18U PJ01A18U FJ01A18U/ M18U	PJ02A20U UJ02A20U FJ02A20U/ M20U YJ02A20U/ M20U	PJ02A25U UJ02A25U FJ02A25U/ M25U YJ02A25U/ M25U	UGJ02A30U FGJ02A30U/ M30U YGJ02A30U/ M30U
A. Overall width	1,065 (41.9)				1,155 (45.5)		1,235 (48.6)
B. Overall height	1,995 (78.5)						2,025 (79.7)
C. Free height	155 (6.1)				150 (5.9)		155 (6.1)
D. Min. ground clearance	115 (4.5)						145 (5.7)
E. Front overhang	400 (15.7)				455 (17.9)		485 (19.1)
F. Rear overhang	390 (15.4)	445 (17.5)	460 (18.1)	495 (19.5)	425 (16.7)	500 (19.7)	525 (20.7)
G. Overall length	3,260 (128.3)	3,315 (130.5)	3,330 (131.1)	3,365 (132.5)	3,600 (141.7)	3,675 (144.7)	3,340 (131.5)
H. Front tread	890 (35.0)				965 (38.0)		1,005 (39.6)
I. Rear tread	900 (35.4)				970 (38.2)		975 (38.4)
J. Wheelbase	1,400 (55.1)				1,650 (65.0)		1,760 (69.3)
K. Overhead guard height	2,060 (81.1)				2,070 (81.5)		2,100 (82.7)

MODEL VARIATION

MODEL VARIATION

MODEL J01 SERIES

Lifting capacity/Load center		Model	Engine	Transmission	Differential carrier	Wheel rim size ... offset mm (in)	Tire
1 ton/500 mm	2,000 lb/20 in	J01M10U	H15	F136E	H263	Front: 5.00F x 10DT ... 0 (0) Rear: 3.00D x 8DT ... 0 (0)	Front: 6.50-10-10PR(I) Rear: 5.00-8-8PR(I)
		J01A10U		F136V			
		PJ01A10U	H20-II	F136V			
		FJ01M10U	TD27	F136E			
		FJ01A10U		F136V			
1.35 ton/500 mm	2,700 lb/20 in	J01M14U	H15	F136E			
		J01A14U		F136V			
		PJ01A14U	H20-II	F136V			
1.5 ton/500 mm	3,000 lb/20 in	J01M15U	H15	F136E			
		J01A15U		F136V			
		PJ01A15U	H20-II	F136V			
		FJ01M15U	TD27	F136E			
		FJ01A15U		F136V			
1.75 ton/500 mm	3,500 lb/20 in	J01M18U	H15	F136E			
		J01A18U		F136V			
		PJ01A18U	H20-II	F136V			
		FJ01M18U	TD27	F136E			
		FJ01A18U		F136V			

MODEL VARIATION

MODEL J02 SERIES

Lifting capacity/Load center		Model	Engine	Transmission	Differential carrier	Wheel rim size ... offset mm (in)	Tire
2 ton/500 mm	4,000 lb/20 in	PJ02A20U	H20-II	F136V	H296	Front: 5.00S x 12DT ... 0 (0) Rear: 4.00E x 9DT ... 0 (0)	Front: 7.00-12-12PR(I) Rear: 6.00-9-10PR(I)
		UJ02A20U	H25	F136V			
		FJ02M20U	TD27	F136E			
		FJ02A20U		F136V			
		YJ02A20U	BD30	F136V			
		YJ02M20U		F136E			
2.5 ton/500 mm	5,000 lb/20 in	PJ02A25U	H20-II	F136V			
		UJ02A25U	H25	F136V			
		FJ02M25U	TD27	F136E			
		FJ02A25U		F136V			
		YJ02M25U	BD30	F136E			
		YJ02A25U		F136V			
3 ton/500 mm	6,000 lb/20 in	UGJ02A30U	H25	F136V	H310	Front: 7.00T x 15IRA ... 47 (1.85) Rear: 5.00F x 10DT ... 0 (0)	Front: 28 x 9-15-12PR(I) Rear: 6.50-10-10PR(I)
		FGJ02M30U	TD27	F136E			
		FGJ02A30U		F136V			
		YGJ02M30U	BD30	F136E			
		YGJ02A30U		F136V			

MODEL VARIATION

PREFIX AND SUFFIX DESIGNATIONS

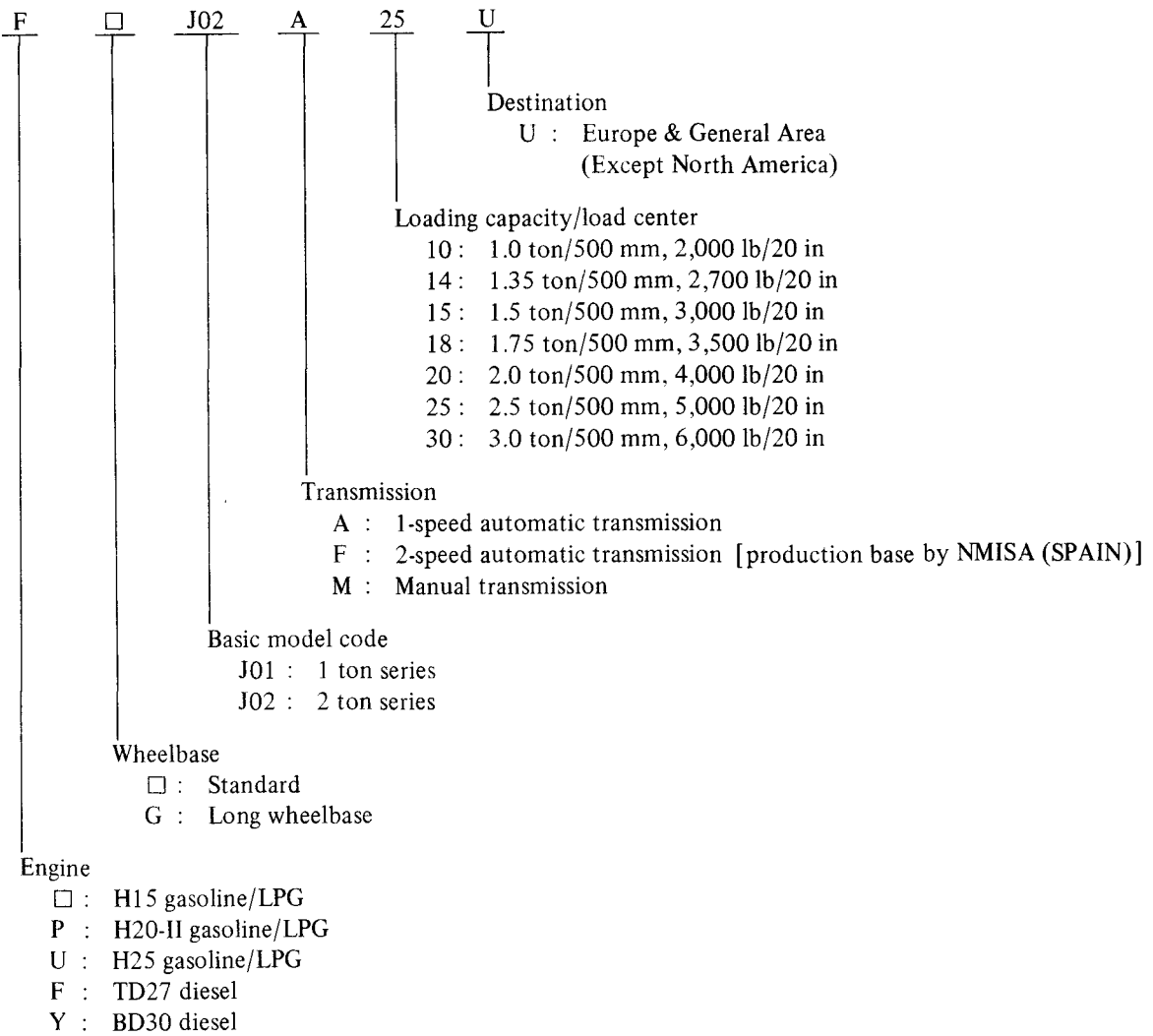

BUY NOW

**Then Instant Download
the Complete Manual
Thank you very much!**